

# TPB2 Parts and Accessories

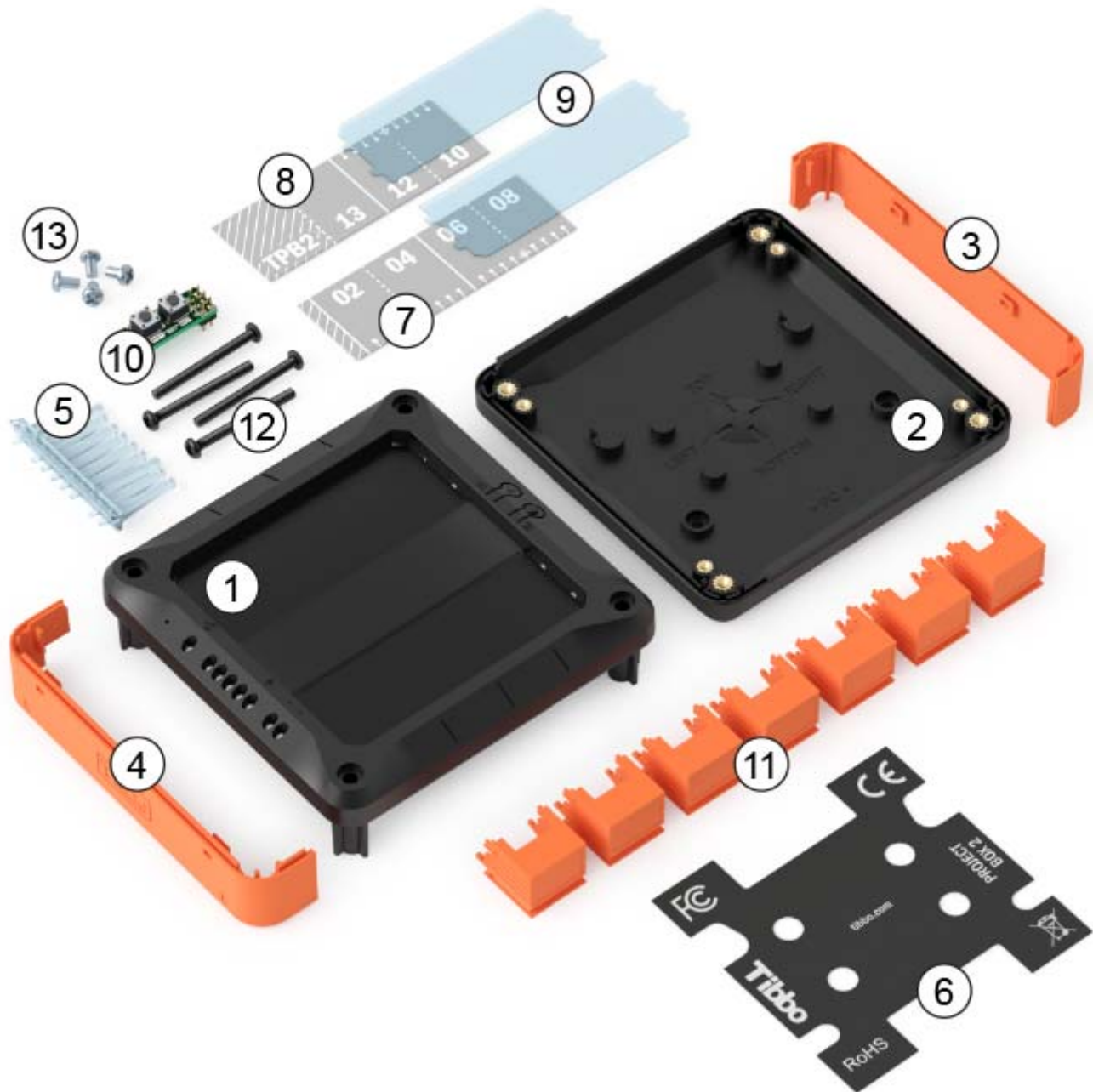

List of parts included with the TPB2 kit

|    | Part       | Description                      | Qty |
|----|------------|----------------------------------|-----|
| 1. | PM01P1054: | Top cover (TPB2)                 | 1   |
| 2. | PM01P1055: | Bottom cover (TPB2, TPB2L)       | 1   |
| 3. | PM01P1049: | Right side wall (all TPB models) | 1   |
| 4. | PM01P1050: | Left side wall (all TPB models)  | 1   |
| 5. | PM06P1004: | LED light guide (all TPB models) | 1   |
| 6. | PM03P1017: | Back label (TPB2, TPB2L)         | 1   |
| 7. | PM921009:  | Paper insert, bottom row (TPB2)  | 1   |

|            |               |  |   |
|------------|---------------|--|---|
| <b>8.</b>  | PM921010:     | Paper insert, top row (TPB2)               | 1 |
| <b>9.</b>  | PM03P1020:    | Paper Insert Cover (TPB2)                  | 2 |
| <b>10.</b> | PCB-P2164:    | MD/RST button PCB (all TPB models)         | 1 |
| <b>11.</b> | PM12P1001-03: | Blank Tibbit shell, C1 form factor, orange | 7 |
| <b>12.</b> | SM3R5+32SPBC: | Main Screw (all TPB models)                | 4 |
| <b>13.</b> | SM2R6+05SPNC: | PCB screw (all TPB models)                 | 4 |

The TPB2 can be purchased with an optional [vibration protection kit \(VPK\)](#), as well as the DIN rail mounting kit.