

| Превышение номинального тока | Время перегорания |
|------------------------------|-------------------|
| 210%                         | 2 мин Max         |
| 275%                         | 400 мс~10 с       |
| 400%                         | 150 мс ~3 с       |
| 1000%                        | 20 мс~150 мс      |

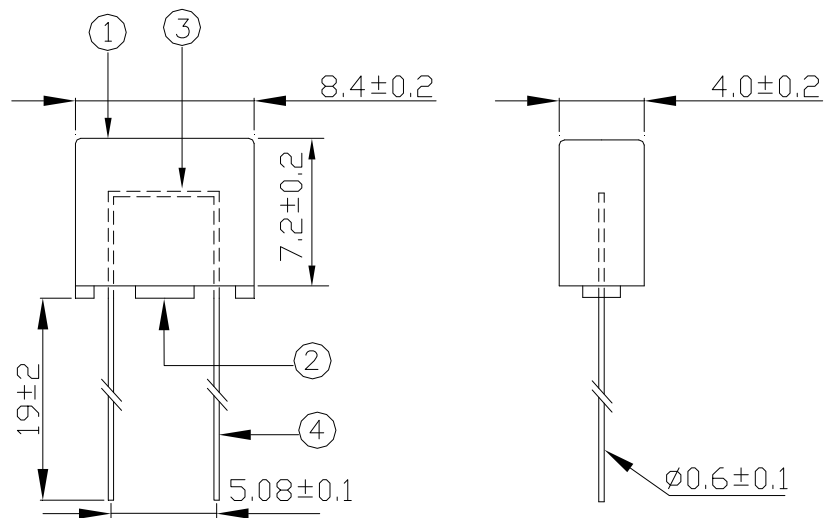

| Наименование | Номинальный ток срабатывания, А |
|--------------|---------------------------------|
| MF02S84-0100 | 0.1                             |
| MF02S84-0125 | 0.125                           |
| MF02S84-0200 | 0.2                             |
| MF02S84-0250 | 0.25                            |
| MF02S84-0315 | 0.315                           |
| MF02S84-0400 | 0.4                             |
| MF02S84-0500 | 0.5                             |
| MF02S84-0630 | 0.63                            |
| MF02S84-0800 | 0.8                             |
| MF02S84-1000 | 1                               |
| MF02S84-1250 | 1.25                            |
| MF02S84-1600 | 1.6                             |
| MF02S84-2000 | 5                               |
| MF02S84-2500 | 2.5                             |
| MF02S84-3150 | 3.15                            |
| MF02S84-4000 | 4                               |
| MF02S84-5000 | 5                               |
| MF02S84-6300 | 6.3                             |

# Time-Current Characteristics 电流-时间曲线图

